

PROJECT:

FIXTURE TYPE:

QUANTITY:

Column 2in

Fluent Lighting's Luminous Column 2in is the perfect addition to any designer's toolkit. With a versatile 2" diameter, it delivers a smooth, even column of vertical light that enhances any space adding sophistication to your interiors.

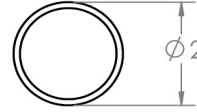

SECTION VIEW

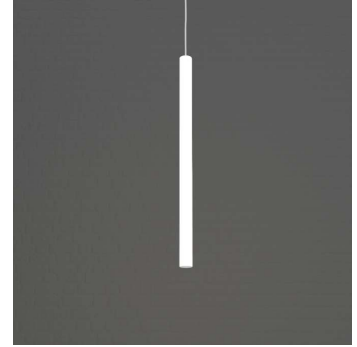

SPECIFICATION CODE

MODEL/DISTRIBUTION	LENGTH (in)	LIGHT SOURCE	VOLTAGE	CCT (K)	CRI	CONTROL	MOUNTING	FINISH	OPTIONS
<input type="text"/>	<input type="text"/>	<input type="text"/>	<input type="text"/>	<input type="text"/>	<input type="text"/>	<input type="text"/>	<input type="text"/>	<input type="text"/>	<input type="text"/>

EXAMPLE

PLC2	36	M 19W	120-277	3500	90	DIM5	PCC/OAH96/REMOTE	RAL7035	
------	----	-------	---------	------	----	------	------------------	---------	--

PLC2
(2" diameter acrylic tube fixture with 360degree illumination)

12	L 4W (375lm, 5lm/sqin)	120-277	2700	90 (min)	DIM1 (0-10V, 1%) PDIM1 (ELV/TRIAC, 1%)
	M 6W (575lm, 7.5lm/sqin)		3000		
	H 8W (750lm, 10lm/sqin)		3500		
24	L 8W (750lm, 5lm/sqin)	120-277	4000	90 (min)	DIM1 (0-10V, 1%) PDIM1 (ELV/TRIAC, 1%)
	M 13W (1125lm, 7.5lm/sqin)		4000		
	H 17W (1500lm, 10lm/sqin)		5000		
36	L 13W (1125lm, 5lm/sqin)	120-277	2700	90 (min)	DIM1 (0-10V, 1%) PDIM1 (ELV/TRIAC, 1%)
	M 19W (1700lm, 7.5lm/sqin)		3000		
	H 25W (2250lm, 10lm/sqin)		3500		
48	L 17W (1500lm, 5lm/sqin)	120-277	4000	90 (min)	DIM1 (0-10V, 1%) PDIM1 (ELV/TRIAC, 1%)
	M 25W (2250lm, 7.5lm/sqin)		4000		
	H 34W (3000lm, 10lm/sqin)		5000		
60	L 21W (1875lm, 5lm/sqin)	120-277	2700	90 (min)	DIM1 (0-10V, 1%) PDIM1 (ELV/TRIAC, 1%)
	M 31W (2825lm, 7.5lm/sqin)		3000		
	H 42W (3775lm, 10lm/sqin)		3500		
72	L 25W (2250lm, 5lm/sqin)	120-277	4000	90 (min)	DIM1 (0-10V, 1%) PDIM1 (ELV/TRIAC, 1%)
	M 38W (3400lm, 7.5lm/sqin)		4000		
	H 50W (4525lm, 10lm/sqin)		5000		
84	L 29W (2650lm, 5lm/sqin)	120-277	2700	90 (min)	DIM1 (0-10V, 1%) PDIM1 (ELV/TRIAC, 1%)
	M 44W (3950lm, 7.5lm/sqin)		3000		
	H 59W (5275lm, 10lm/sqin)		3500		
96	L 34W (3025lm, 5lm/sqin)	120-277	4000	90 (min)	DIM1 (0-10V, 1%) PDIM1 (ELV/TRIAC, 1%)
	M 50W (4525lm, 7.5lm/sqin)		4000		
	H 67W (6025lm, 10lm/sqin)		5000		

PCC/OAH _____
(cord suspended with canopy, pick OAH, white power cord, integral power supply)

PCC/OAH _____ / **REMOTE**
(cord suspended with canopy, pick OAH, white power cord, remote power supply, enclosure included)

WHT
(RAL9010 textured)

BLK
(RAL9005 textured)

RAL _____
(pick color)

MOD _____
(modification to standard product, feasibility to be verified by factory)

RAL
(pick any color from the RAL color standard, finish will be fine textured unless otherwise specified as a MOD)

OAH: 48, 96, 144, 192
(inches, fixture supplied with the above OAH and is field adjustable)

GENERAL SPECIFICATIONS

APPROVAL	ETL listed to UL1598/UL2108 damp location
MIN OPERATING TEMP	-20C (-4F)
MAX OPERATING TEMP	40C (104F)
HOUSING MATERIAL	aluminum
DIFFUSER MATERIAL	UV resistant textured opal acrylic
SUSP. CABLE MATERIAL	power cord
FINISH MATERIAL	polyester powder coat
LUMEN MAINTENANCE	L70 > 50,000 hrs. (@25°C)
WARRANTY	5 year limited warranty

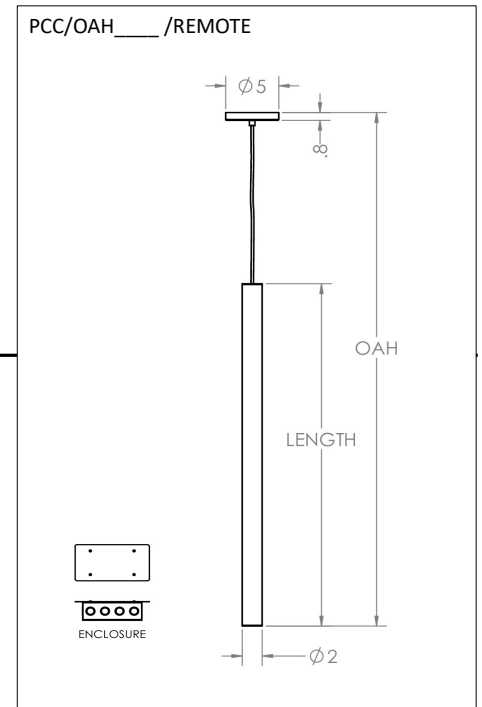
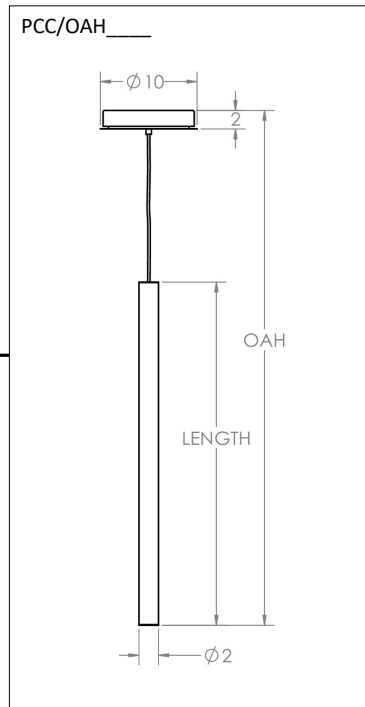

LIGHT SOURCE / PHOTOMETRY

CCT 2700K, 3000K, 3500K, 4000K, 5000K
 COLOR BINNING within 6-step MacAdam ellipse
 CRI 90+ (Ra>90, 75>R9>50)
 LUMEN MAINTENANCE L70 > 50,000 hrs. (@25°C)

AVAILABLE IES FILES www.fluent-lighting.com

OUTPUT MULTIPLIER Lumen values and photometric files created at 3000K, 90 CRI. Please use the following multipliers for different color temperatures and CRI values.

	2700K	3000K	3500K	4000K	5000K
90+	0.91	0.94	0.97	1.00	1.00

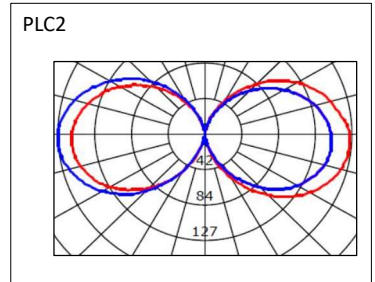

CONTROL

DIM1 (0-10V dimming, 1%)

TYPE electronic
 DIMMING PROTOCOL 0-10V
 MINIMUM DIM LEVEL 1%
 DIMMING CURVE linear
 POWER FACTOR >0.9
 THD <20%
 INPUT 120-277V AC, 50/60HZ

PDIM1 (ELV/TRIAC phase dim, 1%)

TYPE electronic
 DIMMING PROTOCOL ELV and TRIAC phase dimming
 MINIMUM DIM LEVEL 1%
 DIMMING CURVE linear
 POWER FACTOR >0.9
 THD <20%
 INPUT 120-277V AC, 50/60HZ

REMOTE DISTANCES Specific to each lamping/driver combination and can be 100'+, consult factory for specifics.
 Worst case distance: 18ga wire - 15', 16ga wire - 25', 14ga wire - 40', 12ga wire - 60'

MAINTENANCE All drivers are field replaceable.

ALTERNATIVE CONTROLS Contact factory for additional control options.

MOUNTING

PCC (CORD SUSPENDED WITH CANOPY) MOUNTING DETAILS

SIZE (in)	WEIGHT	DRIVERS	CORDS	MINIMUM OAH	INTEGRAL POWER SUPPLY CANOPY DIMENSIONS	REMOTE ENCLOSURES (REMOTE DRIVER OPTION)
12	5 LBS	1	1	18"	10" DIAMETER X 2" HIGH	1
24	5 LBS	1	1	30"	10" DIAMETER X 2" HIGH	1
36	6 LBS	1	1	42"	10" DIAMETER X 2" HIGH	1
48	8 LBS	1-2	1	54"	10" DIAMETER X 2" HIGH	1
60	8 LBS	1-2	1	66"	10" DIAMETER X 2" HIGH	1
72	9 LBS	1-2	1	78"	10" DIAMETER X 2" HIGH	1
84	9 LBS	1-2	1	90"	10" DIAMETER X 2" HIGH	1
96	10 LBS	1-2	1	102"	10" DIAMETER X 2" HIGH	1

NOTES Canopy mounts over 4x4 octagonal j-box (by others.) Cord is white. Cord is field cuttable to adjust OAH. Remote enclosure: contact factory for sizes and options